

- △ USE PRO-CRIMPER II: 354940-1
- 2. USE INSTRUCTION SHEET 9766
- ③ SPECIAL PACKAGING: BULK PACKAGE 25 PIECES
- ④ SPECIAL PACKAGING: BULK PACKAGE 100 PIECES

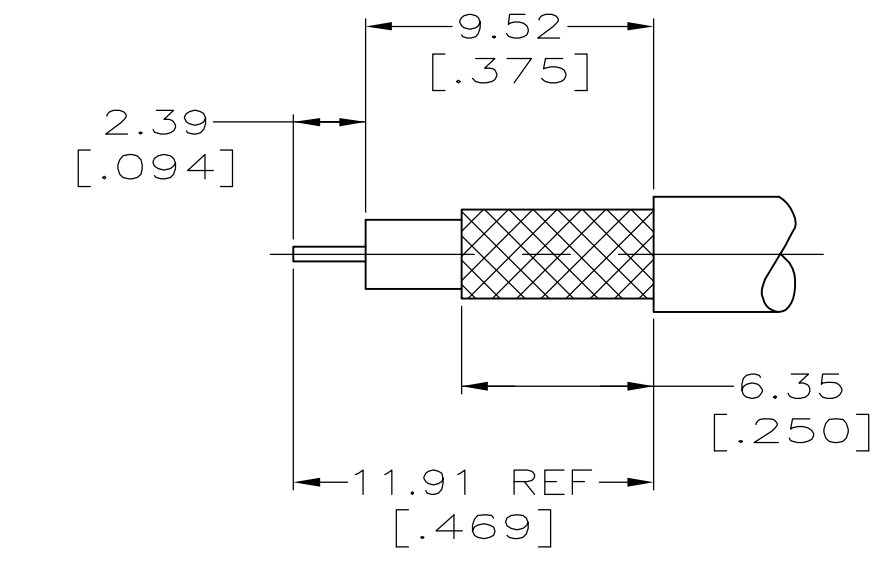

RECOMMENDED STRIP LENGTH
SCALE 4:1

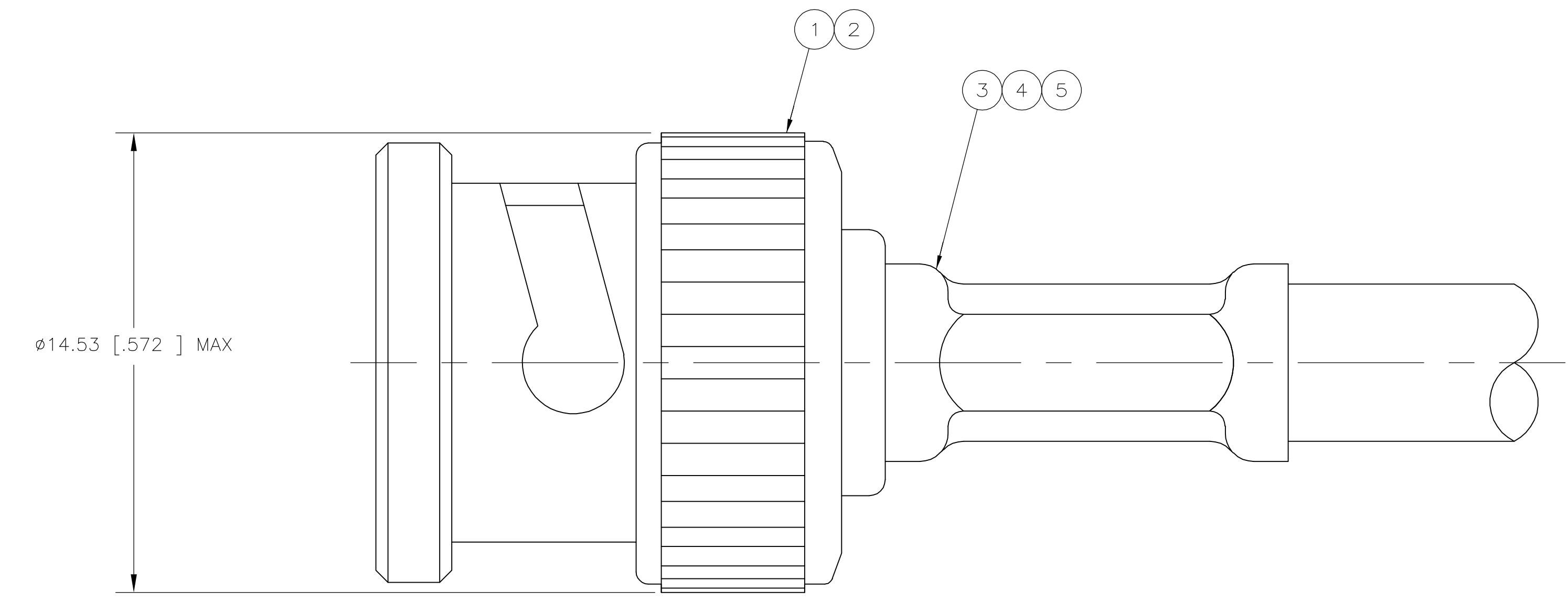
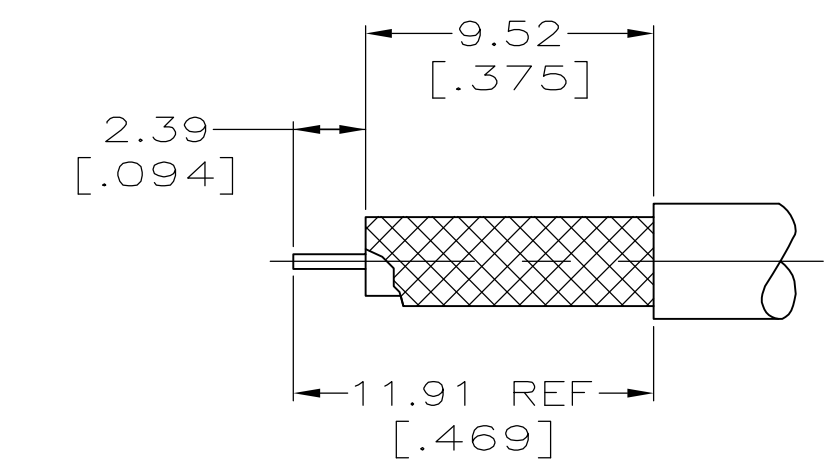

RECOMMENDED STRIP LENGTH
SCALE 4:1
(FOR 413589-5 AND 1-413589-2 ONLY)

△	AT&T KS 19224 L2 CABLE AND JIS 1.5C-XV	1.07	.042	4.52	.178	852922-2	227194-2	222001-4	9-413658-2	413657-6	413653-2	9-413589-6
OBSOLETE △	JIS 3C-2V	1.07	.042	5.41	.213	852922-1	-	-	9-221132-4	1-413657-0	413653-5	9-413589-5
OBSOLETE	RG-59 TYPE WITH .031 DIA CENTER CONTACT, BELDEN 9266, 9240 & 9259	1.07	.042	6.48	.255	852922-1	-	-	9-221132-1	413657-8	413653-1	9-413589-4
OBSOLETE	RG-179/U, 179A/U, 179B/U, 187/U & 187A/U	1.07	.042	4.52	.178	852922-2	227194-2	222001-4	9-413658-0	413657-6	413653-2	9-413589-3
OBSOLETE	AT&T 734A	1.07	.042	6.48	.255	852922-1	-	-	9-221132-3	413657-8	413653-4	9-413589-2
OBSOLETE	BELDEN 8218 AND JIS 2.5C-2V	1.07	.042	4.52	.178	852922-2	-	-	9-221132-6	413657-4	413653-2	9-413589-1
OBSOLETE	RG-59/U, 59A/U & 59B/U	1.07	.042	6.48	.255	852922-1	-	-	9-221132-1	413657-2	413653-1	9-413589-0
△	OBSOLETE CUSTOM CABLE: C/C=ø.021, DIELECTRIC=ø.122, JACKET=ø.173	1.07	.042	5.41	.213	852922-1	-	-	9-221132-0	1-413657-0	413653-5	2-413589-1
OBSOLETE	MONROSE 8466-3 AND 8299-3	1.07	.042	5.41	.213	852922-1	-	-	9-221132-0	1-413657-2	413653-5	1-413589-8
△	OBSOLETE BELDEN 8218 AND JIS 2.5C-2V	1.07	.042	4.52	.178	852922-2	-	-	9-221132-6	413657-4	413653-2	1-413589-7
△	OBSOLETE BELDEN 8218 AND JIS 2.5C-2V	1.07	.042	4.52	.178	852922-2	-	-	9-221132-6	413657-4	413653-2	1-413589-6
OBSOLETE	JIS 2.5C-2W	1.07	.042	5.41	.213	852922-1	-	-	9-221132-0	413657-4	413653-2	1-413589-5
OBSOLETE	JIS 3C-2W	1.07	.042	6.48	.255	852922-1	-	-	9-221132-9	1-413657-0	413653-6	1-413589-4
OBSOLETE	AT&T KS 19224 L2 CABLE AND JIS 1.5C-XV	1.07	.042	4.52	.178	852922-2	227194-2	222001-4	9-413658-2	413657-6	413653-2	1-413589-3
OBSOLETE	BELDEN 8281, 9231 & AT&T 728 AND JIS 5C-2V	1.07	.042	8.23	.324	852922-3	-	-	9-221132-2	413657-8	413653-3	1-413589-2
△	JIS 3C-2V	1.07	.042	5.41	.213	852922-1	-	-	9-221132-4	1-413657-0	413653-5	1-413589-1
△	AT&T 735A C/C=ø.016, DIELECTRIC=ø.077, JACKET=ø.130	1.07	.042	4.52	.178	852922-2	-	-	9-413658-2	413657-4	413653-2	1-413589-0
△	RG-59 TYPE WITH .031 DIA CENTER CONTACT, BELDEN 9266, 9240 & 9259	1.07	.042	6.48	.255	852922-1	-	-	9-221132-1	413657-8	413653-1	413589-9
△	RG-179/U, 179A/U, 179B/U, 187/U & 187A/U	1.07	.042	4.52	.178	852922-2	227194-2	222001-4	9-413658-0	413657-6	413653-2	413589-8
△	AT&T 734A	1.07	.042	6.48	.255	852922-1	-	-	9-221132-3	413657-8	413653-4	413589-7
△	TIMES RG-59/U, DOUBLE BRAID, .270 OD JACKET	1.07	.042	8.23	.324	852922-3	-	-	9-221132-2	413657-2	413653-1	413589-6
△	BELDEN 8281, 9231 & AT&T 728 AND JIS 5C-2V	1.07	.042	8.23	.324	852922-3	-	-	9-221132-2	413657-8	413653-3	413589-5
OBSOLETE	AT&T KS 19224 L2 CABLE AND JIS 1.5C-XV	1.07	.042	4.52	.178	852922-2	227194-2	222001-4	9-413658-2	413657-6	413653-2	413589-4
△	BELDEN 8218 AND JIS 2.5C-2V	1.07	.042	4.52	.178	852922-2	-	-	9-221132-6	413657-4	413653-2	413589-3
△	RG-59/U, 59A/U & 59B/U	1.07	.042	6.48	.255	852922-1	-	-	9-221132-1	413657-2	413653-1	413589-2
OBSOLETE	BELDEN 88241	1.07	.042	6.48	.255	852922-1	-	-	9-413658-3	413657-2	413653-1	413589-1

FOR USE WITH CABLE	CONTACT CRIMP (SQUARE)	FERRULE CRIMP (HEX)	DIE SET △	⑤ TUBING, PLASTIC QTY=1	④ TUBING QTY=1	③ FERRULE QTY=1	② CONTACT QTY=1	① PLUG ASSY QTY=1	PART NUMBER
--------------------	------------------------	---------------------	-----------	-------------------------	----------------	-----------------	-----------------	-------------------	-------------

THIS DRAWING IS A CONTROLLED DOCUMENT.

DIMENSIONS: INCHES	TOLERANCES UNLESS OTHERWISE SPECIFIED:	0 PLC ± -	1 PLC ± -	2 PLC ± -	3 PLC ± 0.41 [.016]	4 PLC ± -	ANGLES ± -	FINISH
--------------------	--	-----------	-----------	-----------	---------------------	-----------	------------	--------

MATERIAL: -

APPROVED: R. E. RUTH 4/30/90

DATE: 4-27-90

BY: D. LAMAN 4/30/90

CHK: R. E. RUTH 4/30/90

NAME: R. E. RUTH

PRODUCT SPEC: -

APPLICATION SPEC: -

SIZE: A1

SCALE: 8:1

SHEET: 1 OF 1

REV: Y2

CUSTOMER DRAWING

SCALE: 8:1

SHEET: 1 OF 1

REV: Y2

RESTRICTED TO: -

TYCO Electronics Tyco Electronics Corporation Harrisburg, PA 17105-3608

PLUG, 75 OHM, HEX CRIMP, BNC

SIZE: A1

DATE CODE: 00779

DRAWING NO: 413589

WEIGHT: -